

105-253 Norton St, Penticton, BC

2nd Floor Exterior Area 663.63 sq ft
Interior Area 592.06 sq ft

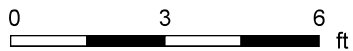

PREPARED: 2025/04/15



White regions are excluded from total floor area in iGUIDE floor plans. All room dimensions and floor areas must be considered approximate and are subject to independent verification.

105-253 Norton St, Penticton, BC

Basement (Below Grade) Exterior Area 500.04 sq ft
Interior Area 433.30 sq ft

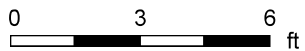

PREPARED: 2025/04/15



105-253 Norton St, Penticton, BC

Main Floor Exterior Area 529.06 sq ft
Interior Area 462.49 sq ft

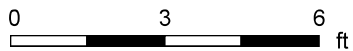
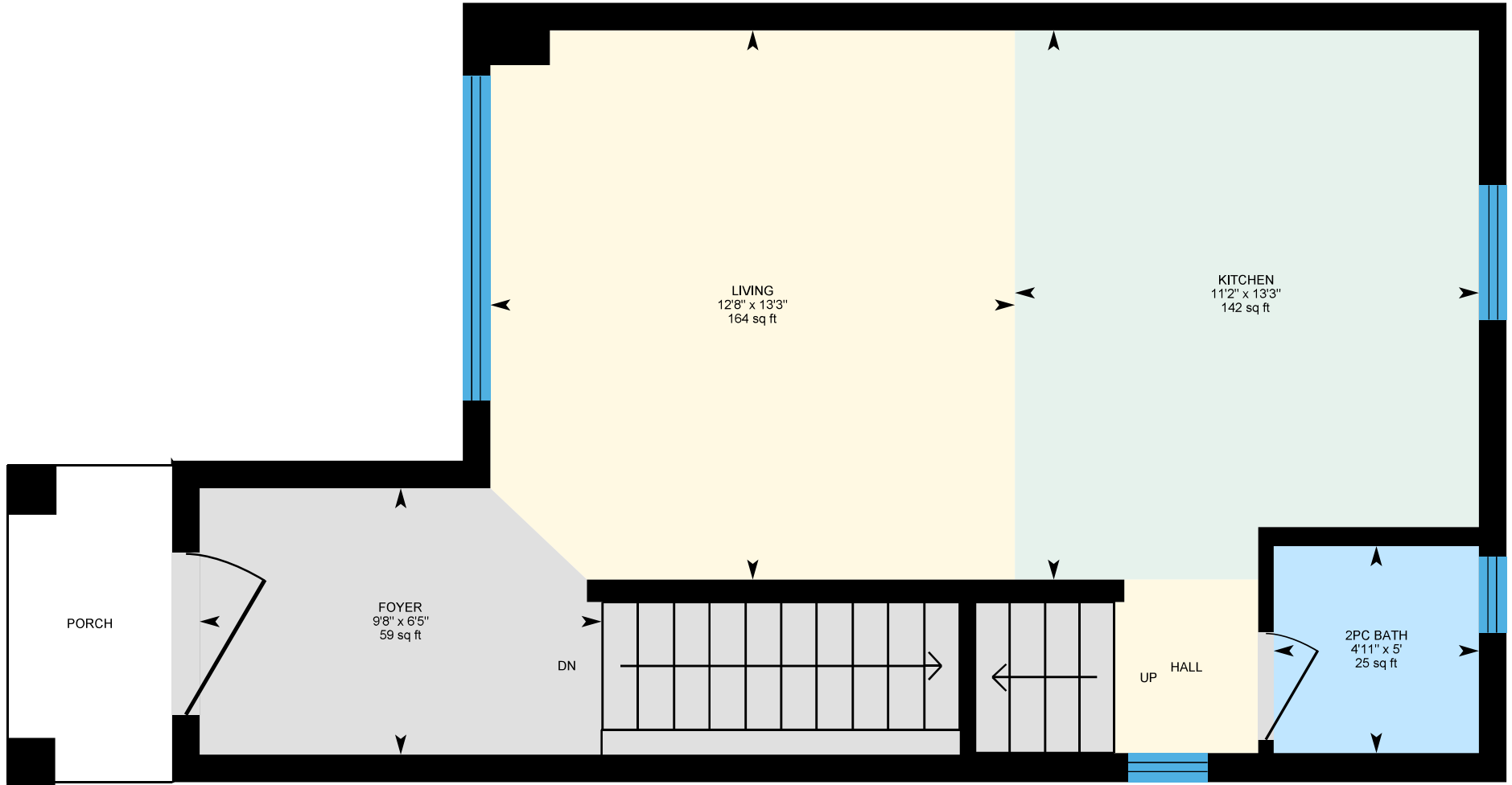

PREPARED: 2025/04/15



White regions are excluded from total floor area in iGUIDE floor plans. All room dimensions and floor areas must be considered approximate and are subject to independent verification.